

southco

PROPRIETARY ITEM - EXCEPT FOR USES EXPRESSLY GRANTED IN WRITING INFORMATION DISCLOSED HEREON IS CONFIDENTIAL AND ALL RIGHTS PATENT AND OTHERWISE ARE RESERVED BY SOUTHCO, INC.

LIFT & TURN COMPRESSION LATCH LOCKING, MID SIZE CUP

DATE	DRAWN	CHKD	SCALE	DRAWING NUMBER
12SEP2008	MHO		NTS	J-N2-2-501

REV	DATE	DRAWN/CHKD	DESCRIPTION
H	07JUL2009	MHO	PRN: P2009-0813
I	12NOV2013	CMS/LW	PRN: P2013-2248
J	28MAY2014	CMS/BGL	PRN: P2014-1016
K	05JUN2020	CMS/CLB	PRN: P2020-1057

ITEM	PART NUMBER	MATERIAL	FINISH
ASSEMBLY	N2-2-501-01-XX	- - -	- - -
HANDLE		ALUMINUM	SEE FINISH TABLE
CUP/STUD ASSEMBLY		SEE NOTE B	SEE FINISH TABLE
LOCK PLATE		STAINLESS STEEL	SEE FINISH TABLE
SLEEVE		STAINLESS STEEL	PASSIVATED
SLEEVE NUT		STAINLESS STEEL	PASSIVATED
TAB WASHER		STAINLESS STEEL	PASSIVATED
SHAFT		STAINLESS STEEL	PASSIVATED
RIVET PIN		STAINLESS STEEL	PASSIVATED
SPRING		STAINLESS STEEL	PASSIVATED
BRASS WEAR WASHER		BRASS	NATURAL
STOP PIN		STAINLESS STEEL	PASSIVATED
LOCKPLUG/CLIP		SEE NOTE A	SEE NOTE A
M12 HEX NUT (2)		STEEL	ZINC ALLOY PLATE BRIGHT CHROMATE
M6 HEX NUT (4)		STEEL	ZINC ALLOY PLATE BRIGHT CHROMATE
M12 LOCKWASHER (2)		STAINLESS STEEL	PASSIVATED
M6 LOCKWASHER (4)		SPRING STEEL	ZINC ALLOY PLATE BRIGHT CHROMATE
M12 TAB WASHER (2)		STAINLESS STEEL	PASSIVATED
LUBRICANT		SEE NOTE D	BLACK
KEYS, CH751 (2)		BRASS	NICKEL PLATED
KEY RING		STEEL	NICKEL PLATED

**AVAILABLE GRIP RANGES
STANDARD PAWLS (SOLD SEPARATELY)**

PART NUMBER	GRIP RANGE	PAWL TYPE
N2-21-101-12	28 - 43	DEEP OFFSET
N2-21-102-12	43 - 58	OFFSET
N2-21-103-12	58 - 73	FLAT
N2-21-104-12	73 - 88	OFFSET
N2-21-105-12	88 - 104	DEEP OFFSET

FINISH TABLE

-X	FINISH
-5	BLACK POWDER COATED
-20	POLISHED STAINLESS

MILLIMETERS

ALL DIMENSIONS WITHOUT TOLERANCES ARE FOR REFERENCE ONLY.

THIRD ANGLE PROJECTION A3 PAPER SIZE

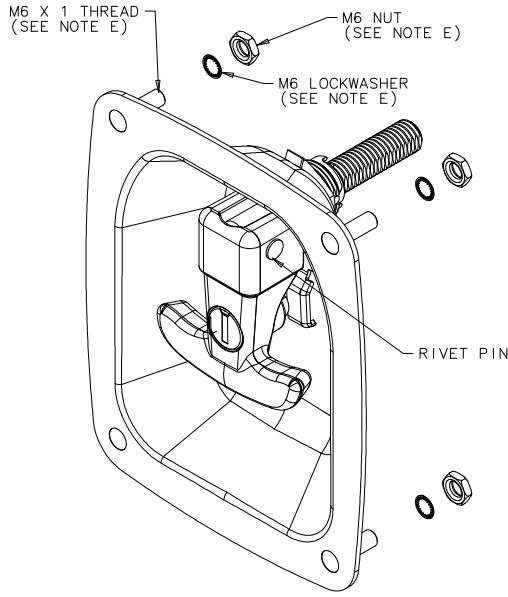

- NOTES:
- LOCKPLUG MATERIAL AND FINISH:
LOCKPLUG: DIE CAST ZINC, CHROMATE FINISH
SCALP AND DUST SHUTTER: STAINLESS STEEL
 - CUP/STUD ASSEMBLY MATERIAL:
CUP: STEEL
STUD: STAINLESS STEEL
 - LOCK TO FUNCTION WITH KEY CODE CH751.
 - LUBRICANT MATERIAL: OIL BASED GREASE WITH MOLYBDENUM DISULFIDE ADDITIVES.
 - INSTALLATION:
1. PLACE LATCH IN PANEL AND USE (4) M6 X 1 NUTS AND (4) M6 LOCKWASHERS AND INSTALL TO A MAXIMUM RECOMMENDED TIGHTENING TORQUE OF 7.2 Nm.
2. FINAL INSTALLATION WILL REQUIRE ADJUSTMENT TO THE PAWL.
(M12 LOCKNUT TIGHTENING TORQUE: 20-25Nm)

