

| REVISION HISTORY | | | |
|------------------|-----------|--------|-----------------|
| REV | DATE | BY | DESCRIPTION |
| C | 01DEC2020 | SSG/VK | PRN: P2020-2210 |

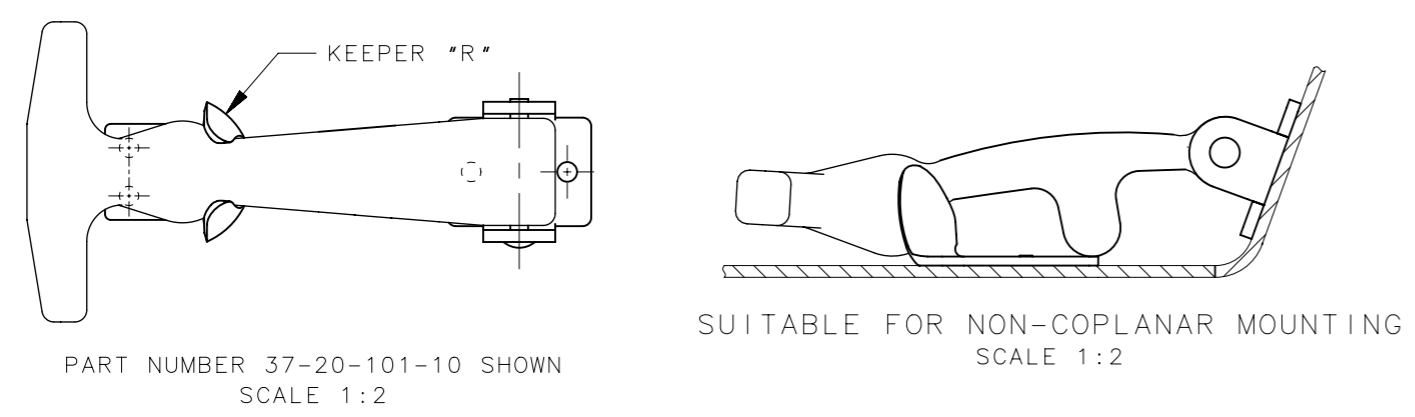
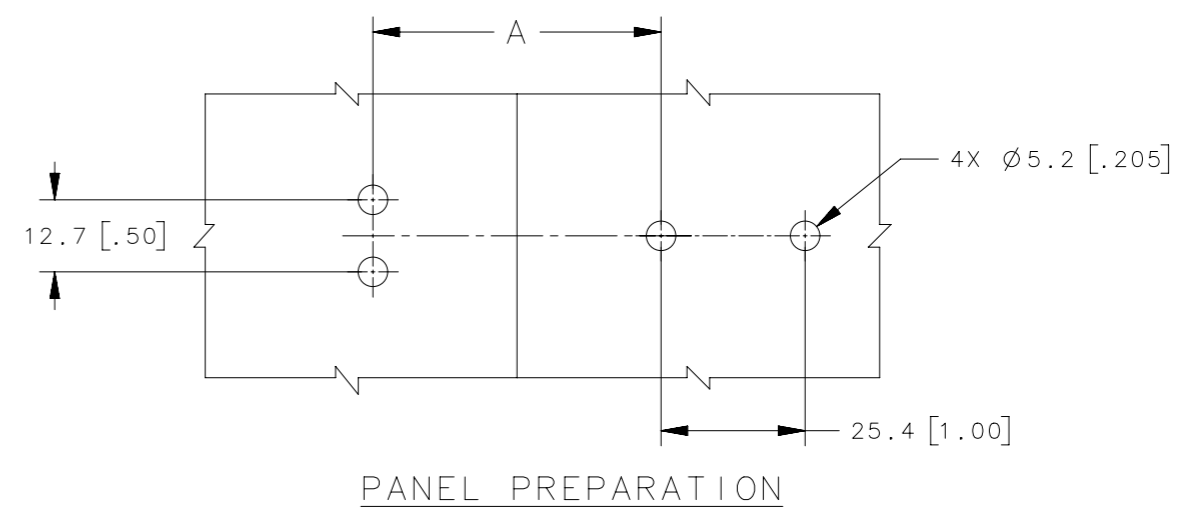
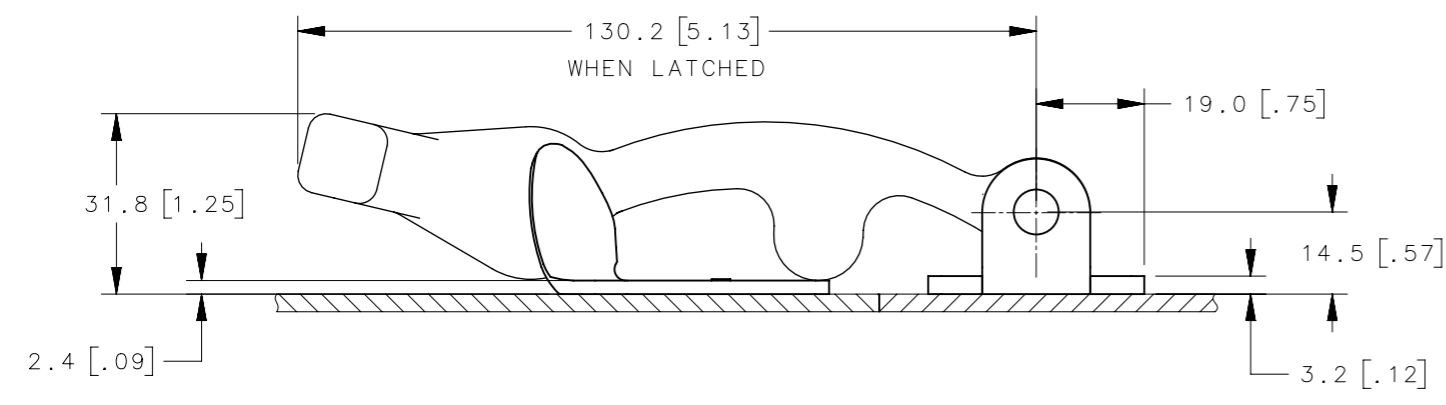
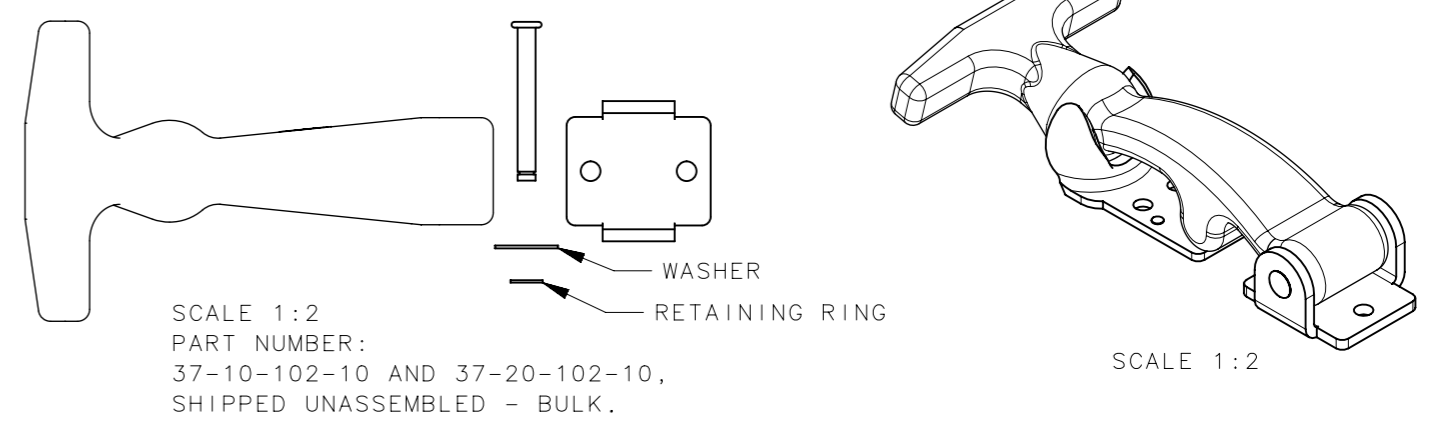
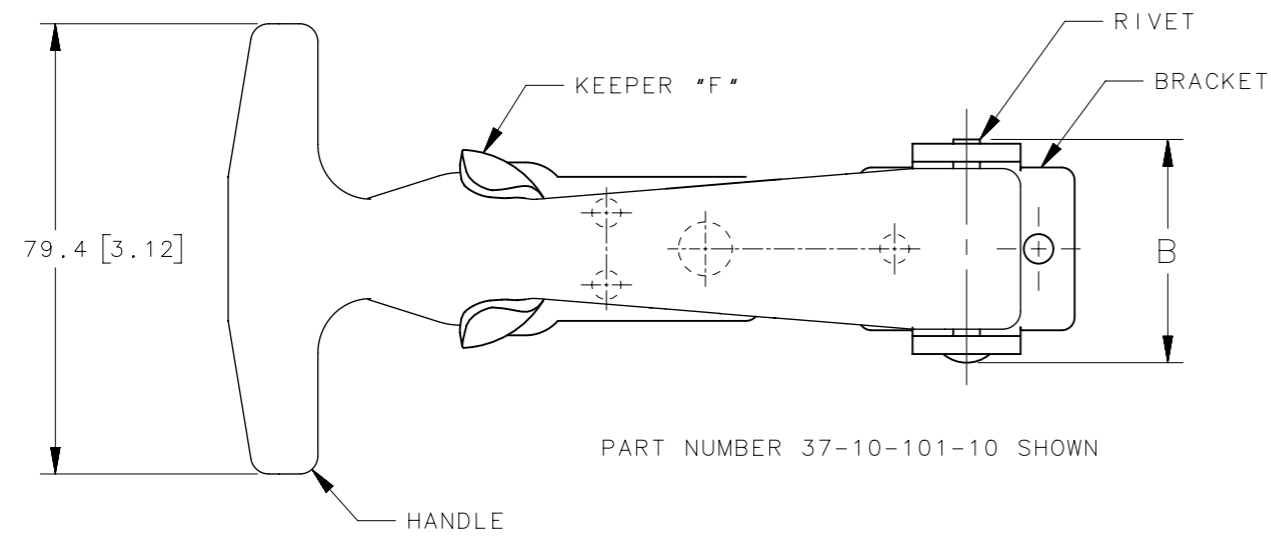

| | | | | | | | | |
|----------------|----------------------------|--------------------|------------|-------------------|------------|-------------|------------|------------|
| 37-10-101-10-P | LATCH ASSEMBLY, SEE NOTE 4 | - | - | - | - | - | 50.8[2.00] | 39.3[1.55] |
| 37-20-102-10 | LATCH SHIPPED UNASSEMBLED | EPDM RUBBER, BLACK | SEE NOTE 2 | SEE NOTE 2 | SEE NOTE 2 | R | 90.5[3.56] | 42.1[1.66] |
| 37-10-102-10 | LATCH SHIPPED UNASSEMBLED | EPDM RUBBER, BLACK | SEE NOTE 2 | SEE NOTE 2 | SEE NOTE 2 | F | 50.8[2.00] | 42.1[1.66] |
| 37-25-101-24 | KEEPER | - | - | - | SEE NOTE 3 | R | - | - |
| 37-11-101-20 | HANDLE SUB-ASSEMBLY | EPDM RUBBER, BLACK | SEE NOTE 3 | SEE NOTE 3 | - | - | - | - |
| 37-20-101-20 | LATCH, ASSEMBLED | - | - | - | - | - | 90.5[3.56] | 39.3[1.55] |
| 37-15-101-24 | KEEPER | - | - | - | SEE NOTE 3 | F | - | - |
| 37-11-101-20 | HANDLE SUB-ASSEMBLY | EPDM RUBBER, BLACK | SEE NOTE 3 | SEE NOTE 3 | - | - | - | - |
| 37-10-101-20 | LATCH, ASSEMBLED | - | - | - | - | - | 50.8[2.00] | 39.3[1.55] |
| 37-25-101-17 | KEEPER | - | - | - | SEE NOTE 2 | R | - | - |
| 37-11-101-10 | HANDLE SUB-ASSEMBLY | EPDM RUBBER, BLACK | SEE NOTE 2 | ALUMINUM, NATURAL | - | - | - | - |
| 37-20-101-10 | LATCH, ASSEMBLED | - | - | - | - | - | 90.5[3.56] | 39.3[1.55] |
| 37-15-101-17 | KEEPER | - | - | - | SEE NOTE 2 | F | - | - |
| 37-11-101-10 | HANDLE SUB-ASSEMBLY | EPDM RUBBER, BLACK | SEE NOTE 2 | ALUMINUM, NATURAL | - | - | - | - |
| 37-10-101-10 | LATCH, ASSEMBLED | - | - | - | - | - | 50.8[2.00] | 39.3[1.55] |
| PART NUMBER | TYPE OF COMPONENT | HANDLE | BRACKET | RIVET/STUD | KEEPER | KEEPER TYPE | A | B |
| | | MATERIAL, FINISH | | | | | | |

- NOTES:
1. LATCH AND KEEPER SHIPPED SEPARATELY, BULK.
 2. STEEL, ZINC PLATE, BRIGHT CHROMATE PLUS SEALER.
 3. STAINLESS STEEL, PASSIVATED.
 4. 37-10-101-10-P IS PACKAGED ONE LATCH AND ONE KEEPER PER BAG.

| | | | |
|--|---|--|---------------------|
| THIRD ANGLE PROJECTION | | southco [®] CONNECT • CREATE • INNOVATE | |
| MILLIMETERS [IN] | | | |
| SURFACE AREA | TOLERANCES UNLESS OTHERWISE NOTED | DESCRIPTION | |
| VOLUME | ALL DIMENSIONS WITHOUT TOLERANCES ARE FOR REFERENCE ONLY. | 37 FLEXIBLE DRAW LATCH 100 SERIES, T-HANDLE | |
| PROPRIETARY ITEM | PER ASME Y14.5M-1994 | SIZE A3 | SYSTEM NX |
| EXCEPT FOR USES EXPRESSLY GRANTED IN WRITING, INFORMATION DISCLOSED HEREON IS CONFIDENTIAL AND ALL RIGHTS, PATENT AND OTHERWISE, ARE RESERVED BY SOUTHCO, INC. | DRAWN BY DMS/YGC | DATE 24NOV2015 | DWG NO. J-37-100 |
| | | SCALE 0.75:1 | SHEET 1 OF 1 |