

NOTES:

- A. COSMETIC SPECIFICATION:
ALL SURFACES ARE TO CONFORM TO A CLASS *D* DESIGNATION AS DESCRIBED IN SOUTHCO COSMETIC SPECIFICATION S-121-02 FOR ZINC PLATING.
- B. RoHS COMPLIANT.

southco

PROPRIETARY ITEM - EXCEPT FOR USES EXPRESSLY GRANTED IN WRITING INFORMATION DISCLOSED HEREON IS CONFIDENTIAL AND ALL RIGHTS PATENT AND OTHERWISE ARE RESERVED BY SOUTHCO, INC.

DM DUOSERT INSERT - M6 THREAD
(FOR 1.2mm PANEL)

DATE	DRAWN	CHKD	SCALE
22JUN2005	AJH		3:1

DRAWING NUMBER
J-DM-95-10

REV	DATE	DRAWN/CHKD	DESCRIPTION	ITEM	PART NUMBER	MATERIAL	FINISH
A	29JUN2005	AJH/MDY	PRN: P2005-0796	ASSEMBLY	DM-95-10-12-11	-	-
B	30SEP2005	AJH/MDY	PRN: P2005-1337	NUT	-	DIE CAST ZINC	ZINC, CHROMATE CONVERSION COATING
				CAGE	-	STAINLESS STEEL	NATURAL

MILLIMETERS

ALL DIMENSIONS WITHOUT TOLERANCES ARE FOR REFERENCE ONLY.

THIRD ANGLE PROJECTION

A3 PAPER SIZE

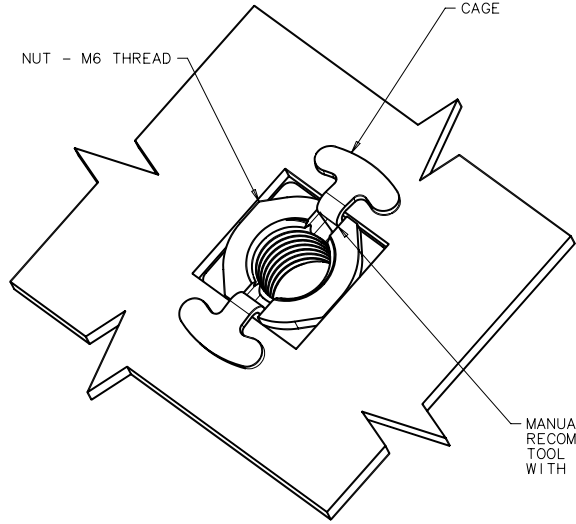

PLACE DUOSERT INTO PANEL, ROTATE INTO PLACE

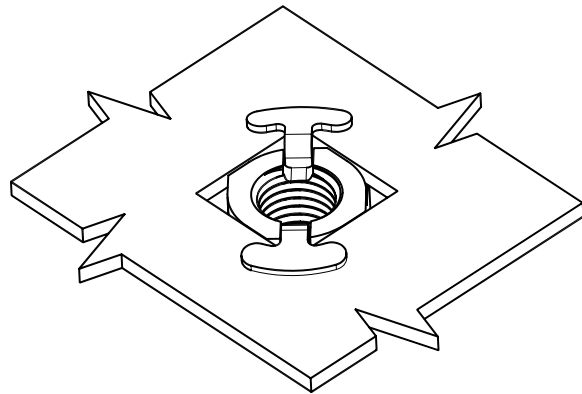

INSTALLED

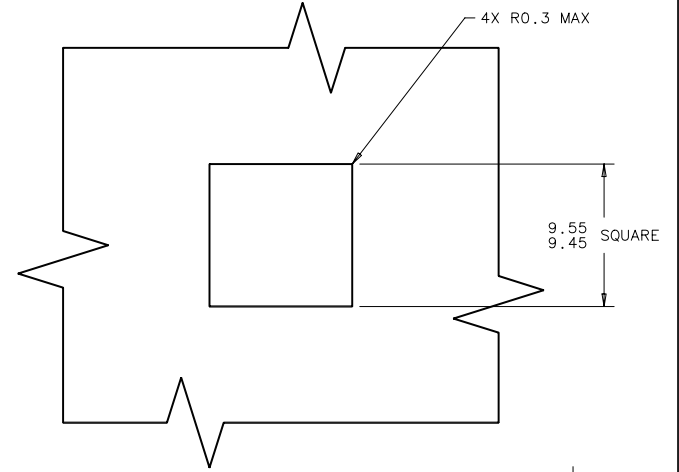

PANEL PREPARATION

PANEL PREPARATION INCLUDES ANY PLATING OR COATING

1.2 ± 0.1
PANEL THICKNESS

