

REVISION HISTORY			
REV	DATE	BY	DESCRIPTION
C	12JUL2019	DPZ/ACH	PRN: P2019-1787

SOUTHCO PERFORMANCE GUIDELINES

THE PERFORMANCE GUIDELINES SHOWN ON THIS PAGE ARE SUPPLIED AS A GENERAL GUIDE ONLY. AS CONDITIONS VARY WITH EACH APPLICATION AND METHOD OF INSTALLATION, STRENGTH DATA IS GIVEN FOR FAILURE OF THE PRODUCT OR FOR SUFFICIENT DEFORMATION TO MAKE THE PRODUCT INOPERABLE. NO SAFETY FACTOR HAS BEEN APPLIED. IT IS RECOMMENDED THAT THE USER REQUEST A PRODUCT SAMPLE FOR TESTING TO DETERMINE THE SUITABILITY OF THE PRODUCT FOR THE PURPOSE INTENDED AND USER'S PARTICULAR APPLICATION.

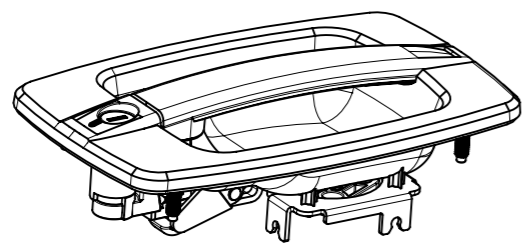

AC-10-3Y1-11: MULTIPOINT W/ CABLE BRACKET

1. ULTIMATE STRENGTH TESTS WERE PERFORMED WITH PART NUMBER AC-10-351-11.
2. CONSULT SOUTHCO FOR OTHER TECHNICAL DETAILS.
3. CYCLE TEST PERFORMED WITH 35LB ON THE ROTATOR PLATE

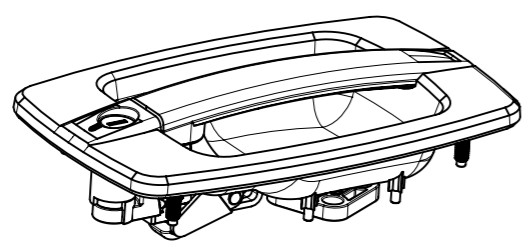

AC-10-2Y1-11: MULTIPOINT W/O CABLE BRACKET

	AVERAGE ULTIMATE STRENGTH		INSTALLATION TORQUE	CYCLE LIFE
	LOCKED	UNLOCKED		
AC-10-3Y1-11	2580 N	2510 N	7 N-m MAX	40,000
AC-10-2Y1-11				
AC-10-EM-3Y1-11				

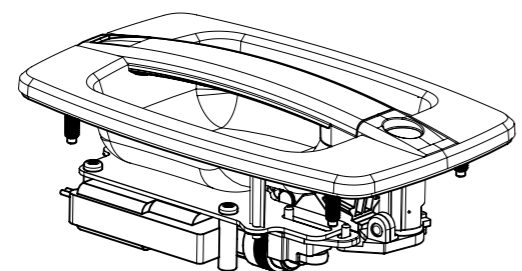

AC-10-EM-3Y1-11: MULTI-POINT W/ CABLE BRACKET & LOCK/UNLOCK ELECTRONIC ACTUATOR

NOTE:  
SOUTHCO ACTUATOR USED IN A PASSENGER RESTRAINT SYSTEM MUST BE FULLY TESTED IN THE DOOR SYSTEM

THIRD ANGLE PROJECTION		
TOLERANCES UNLESS OTHERWISE NOTED	DESCRIPTION	
UP TO 0.5    ±0.05	AC-10 ACTUATOR HANDLE	
OVER 0.5 UP TO 6    ±0.1	SIZE	SYSTEM
OVER 6 UP TO 30    ±0.2	A3	NX
OVER 30    ±0.3	DWG NO. TD-AC-10	
ANGLES    ±1°	DRAWN BY	DATE
PER ASME Y14.5M-1994	ASM	08SEPT2014
	SCALE	SHEET
	2:5	1 OF 1