

6

5

4

3

2

1

HAND ACTUATION

BOTTOM ACTUATION

TOP ACTUATION

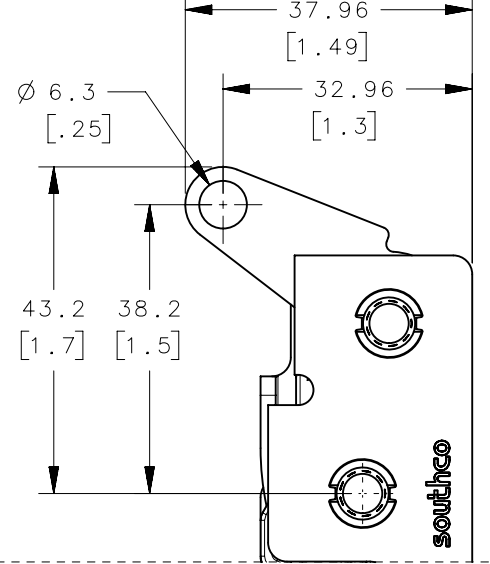
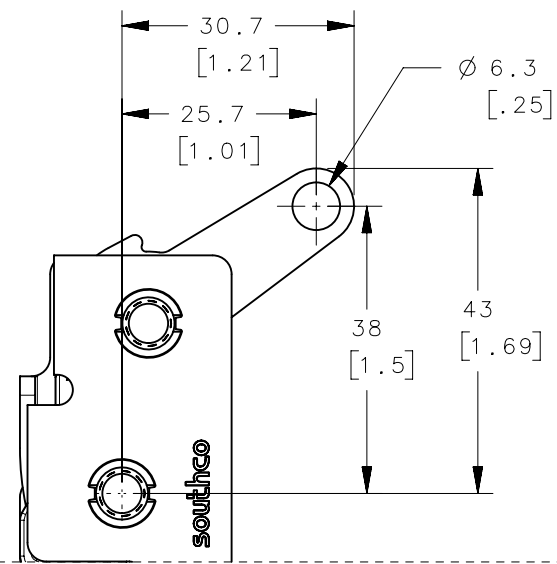
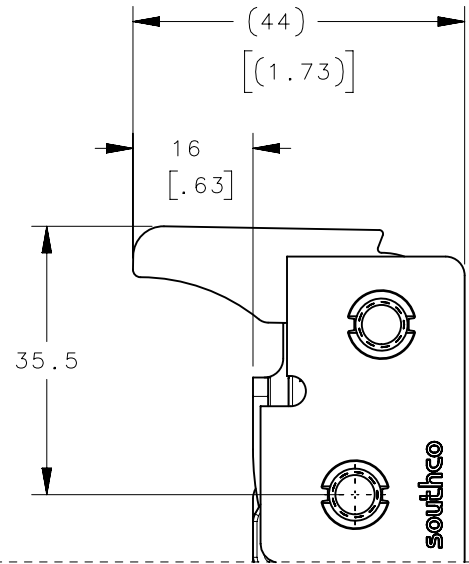

REVISION HISTORY			
REV	DATE	BY	DESCRIPTION
C	02MAR2018	DKM/DMS	PRN: P2018-0542

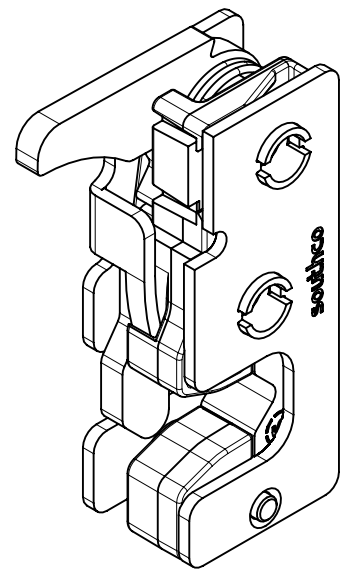

PANEL PREPERATION

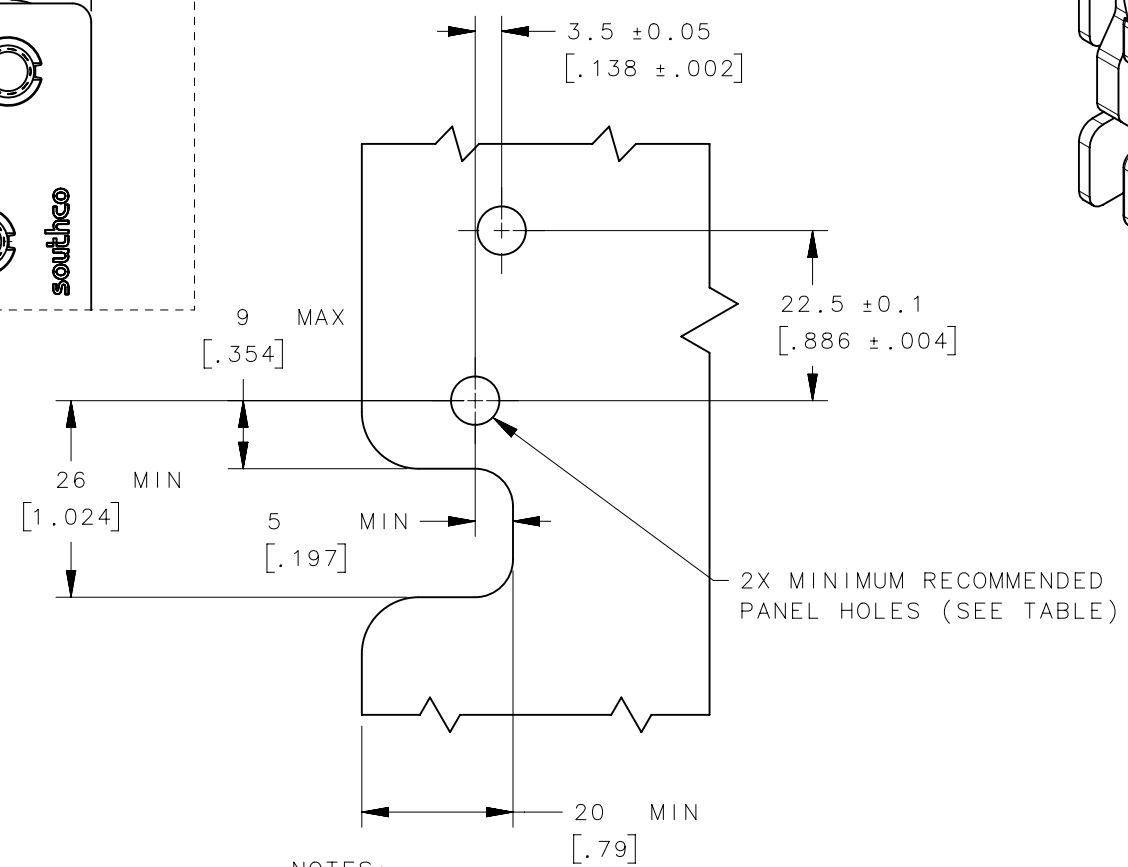

BOTTOM ACTUATION SHOWN

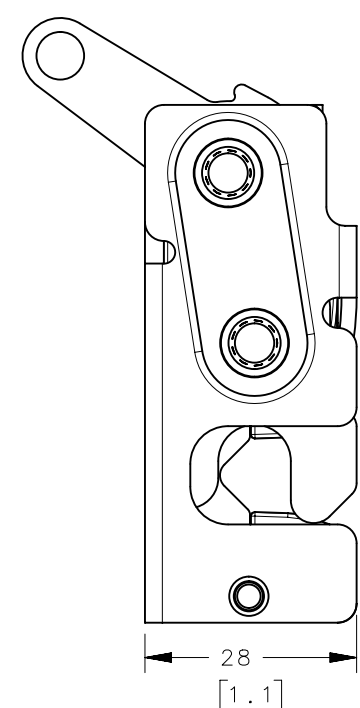
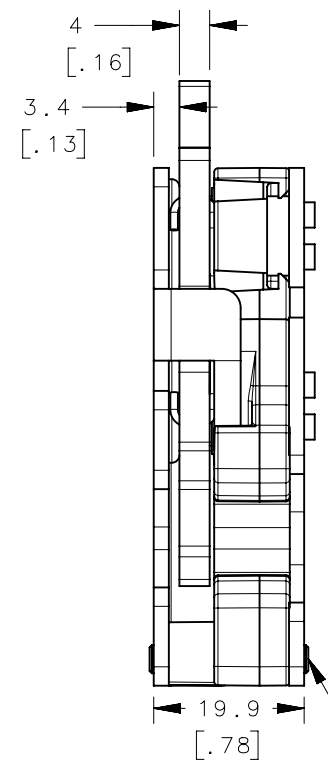
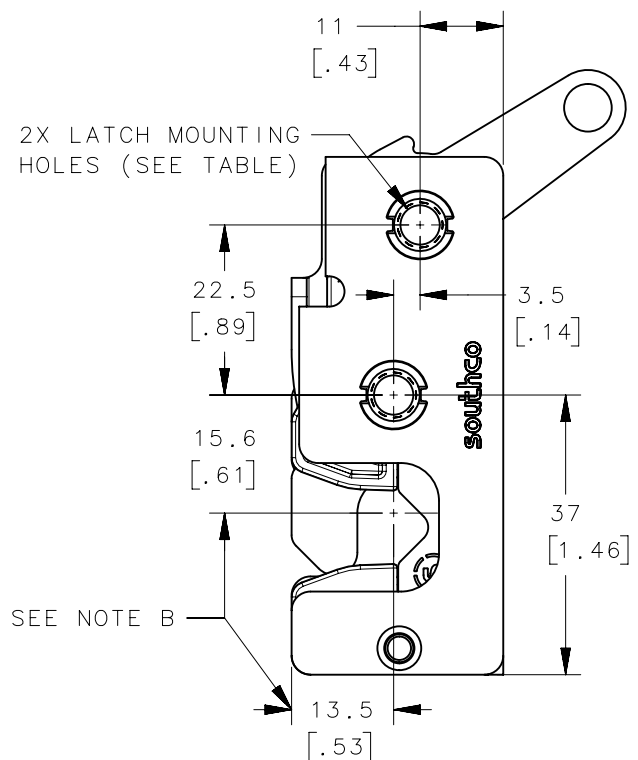

- NOTES:
- A. MATERIAL:
    - HOUSING, LEVER AND INTERNAL COMPONENTS: STEEL
    - PAWL AND TRIGGER: HARDENED STEEL
    - SPRING: STAINLESS STEEL, PASSIVATED
  - B. THESE DIMENSIONS REQUIRED FOR MOUNTING STRIKER BOLT.

ASSEMBLY PART No. R4-10--05-

AFTER RIVETING, PIN TO BE RIVETED FLUSH WITH FRAMES

STAGE & ACTUATION

- 1 - SINGLE STAGE, RIGHT HAND
- 3 - TWO-STAGE, RIGHT HAND

MOUNTING STYLE

- 0 - Ø7.2 (.283) THRU
- 1 - 1/4-20 THREAD
- 2 - M6x1 THREAD

LEVER TYPE

- 4 - HAND ACTUATION
- 5 - BOTTOM ACTUATION
- 6 - TOP ACTUATION

FINISH

- 10 - ZINC PLATE, BRIGHT CHROMATE
- 77 - ZINC NICKEL, BRIGHT CHROMATE

THIRD ANGLE PROJECTION	
MILLIMETERS [IN]	
TOLERANCES UNLESS OTHERWISE NOTED	
ALL DIMENSIONS WITHOUT TOLERANCES ARE FOR REFERENCE ONLY.	
PER ASME Y14.5M-1994	

**southco**  
CONNECT • CREATE • INNOVATE

DESCRIPTION: R4 MINI ROTARY LATCH  
RIGHT HAND - BSR INSERT

SIZE: B	SYSTEM: NX	DWG NO.: J-R4-10-5BR
DRAWN BY: CMG/DGJ	DATE: 16JUN2014	SCALE: 1:1 SHEET: 1 OF 3

6

5

4

3

2

1

REVISION HISTORY			
REV	DATE	BY	DESCRIPTION
C	02MAR2018	DKM/DMS	PRN: P2018-0542

HAND ACTUATION SHOWN

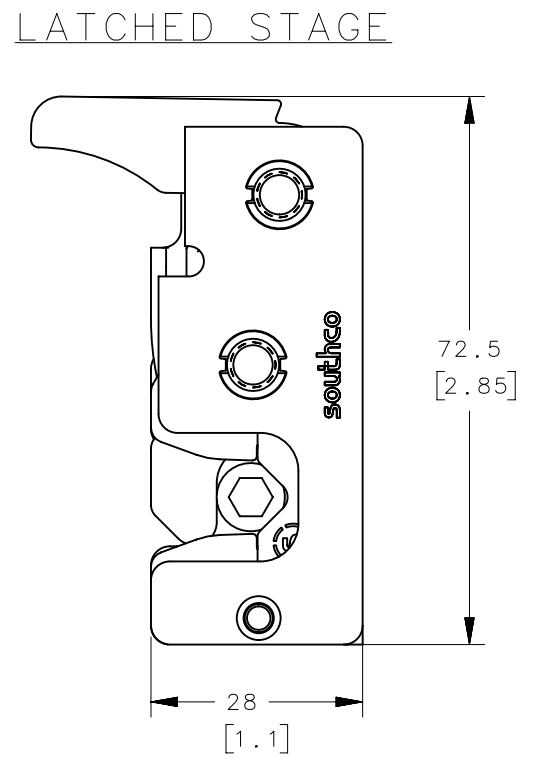
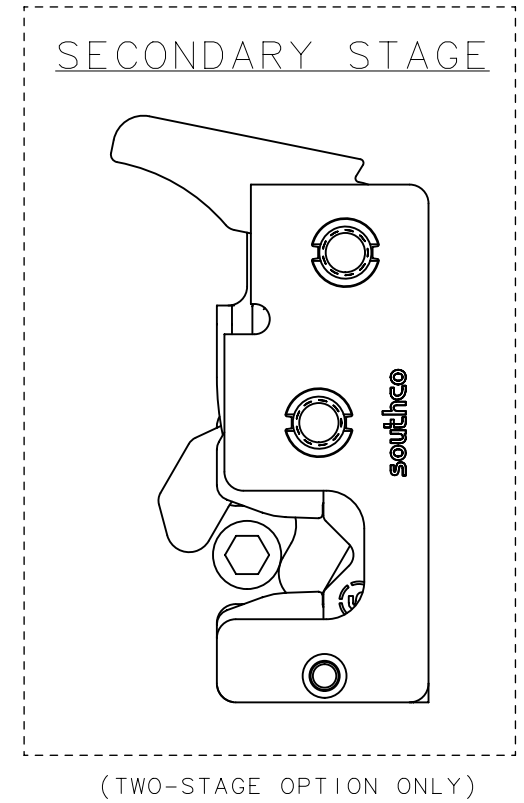
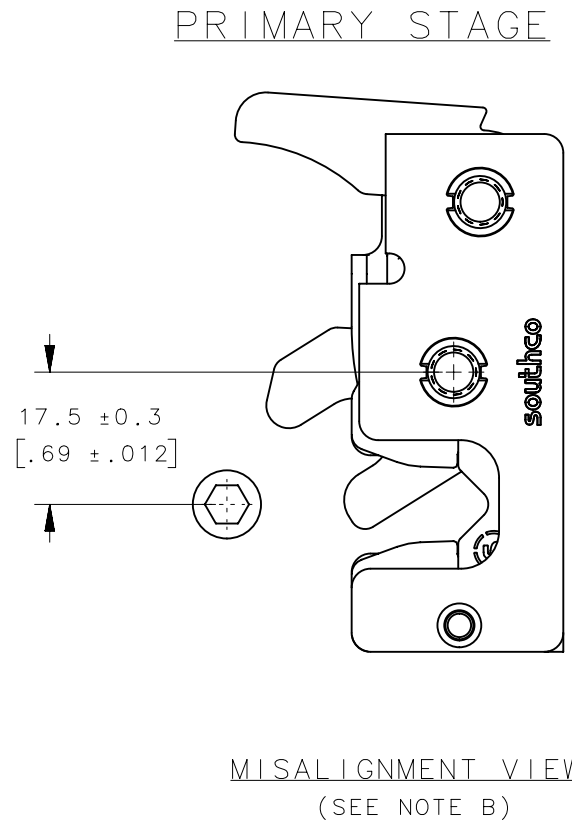
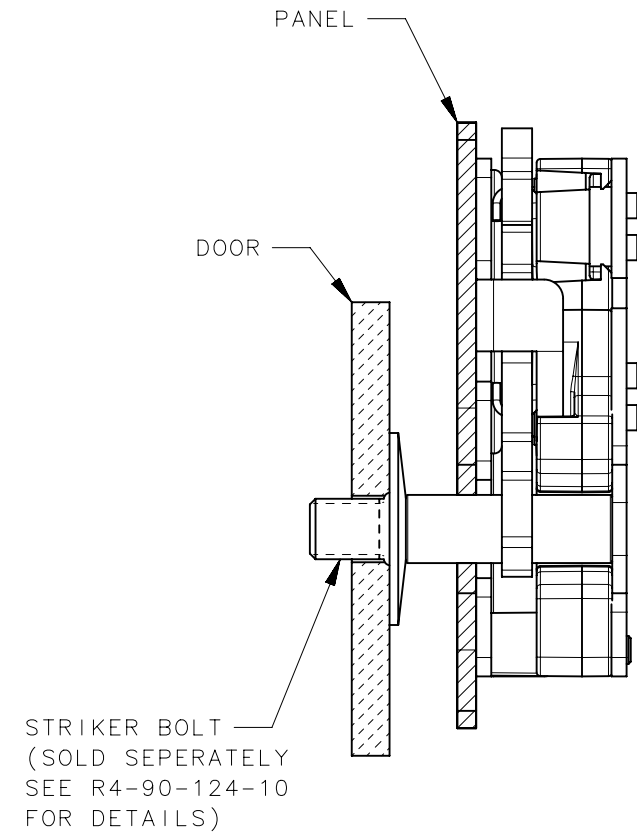

NOTES:

- A. THE TOLERANCE BETWEEN THE LATCH AND STRIKER BOLT ASSUMES A NON-RIGID DOOR INSTALLATION THAT WILL ALLOW THE DOOR TO MOVE INTO THE NOMINAL POSITION DURING LATCHING. RIGID DOORS MUST HAVE THE STRIKER INSTALLED PER THE PANEL PREPARATION RECOMMENDATION.
- B. THE MISALIGNMENT VIEW ASSUMES THE LATCH IS CONNECTED TO A PERFECTLY RIGID DOOR AND HINGE; THEREFORE, THERE IS NO DOOR AND/OR HINGE SLACK ASSOCIATED WITH THESE DIMENSIONS. THE MISALIGNMENT VIEW DOES NOT TAKE FLEXING OF THE STRIKER BOLT INTO ACCOUNT.

R4-10-X0-X05-XX	Ø 7.2 THRU	Ø 7.2 [.299]
R4-10-X1-X05-XX	1/2-20 THREAD	Ø 6.8 [.268]
R4-10-X2-X05-XX	M6X1 THREAD	Ø 6.4 [.252]
PART NUMBER	MOUNTING STYLE	MINIMUM PANEL HOLE

THIRD ANGLE PROJECTION			 CONNECT · CREATE · INNOVATE	
MILLIMETERS [IN]				
TOLERANCES UNLESS OTHERWISE NOTED	DESCRIPTION R4 MINI ROTARY LATCH RIGHT HAND - BSR INSERT			
ALL DIMENSIONS WITHOUT TOLERANCES ARE FOR REFERENCE ONLY.	SIZE B	SYSTEM NX	DWG NO. J-R4-10-5BR	
PER ASME Y14.5M-1994	DRAWN BY CMG/DGJ	DATE 16JUN2014	SCALE 1:1	SHEET 2 OF 3

PROPRIETARY ITEM  
EXCEPT FOR USES EXPRESSLY GRANTED IN WRITING, INFORMATION DISCLOSED HEREON IS CONFIDENTIAL AND ALL RIGHTS, PATENT AND OTHERWISE, ARE RESERVED BY SOUTHCO, INC.

6

5

4

3

2

1

REVISION HISTORY			
REV	DATE	BY	DESCRIPTION
C	02MAR2018	DKM/DMS	PRN: P2018-0542

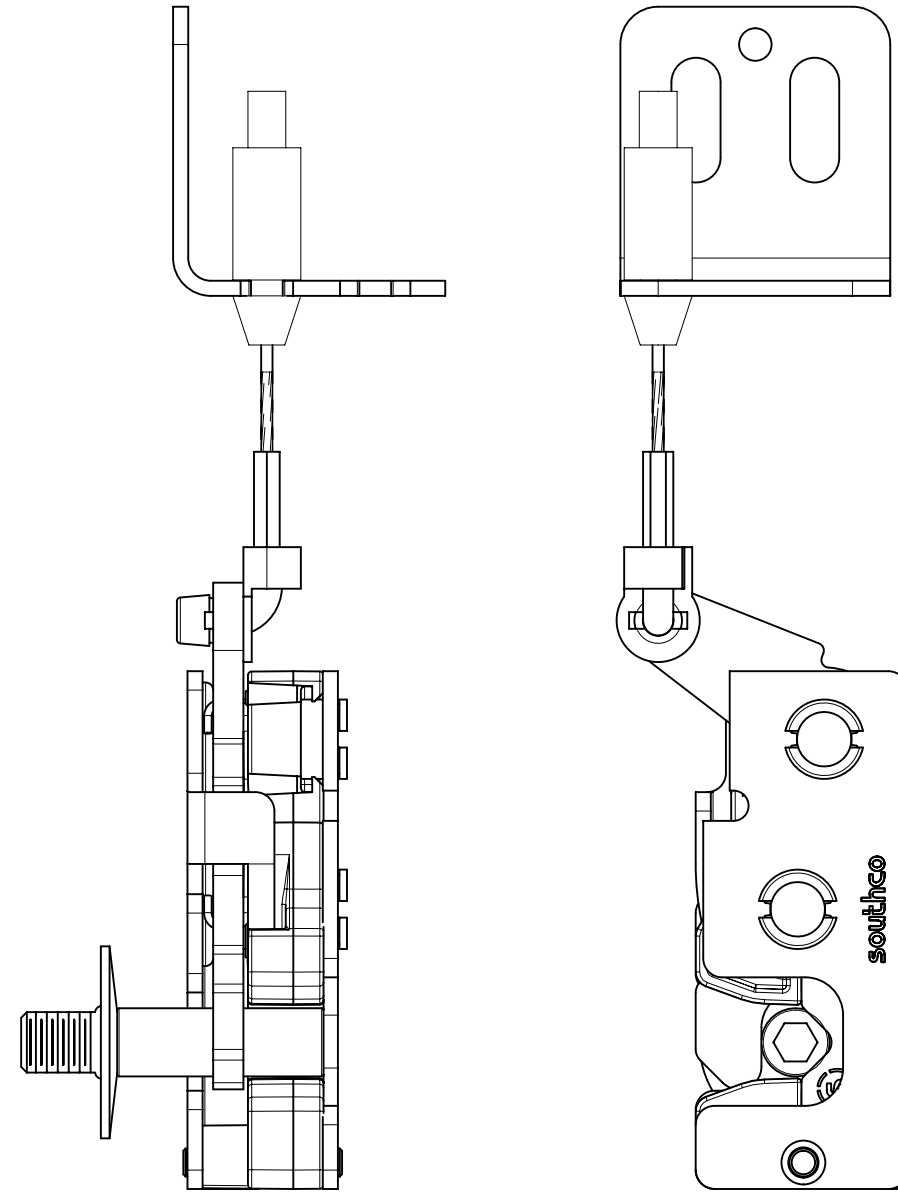
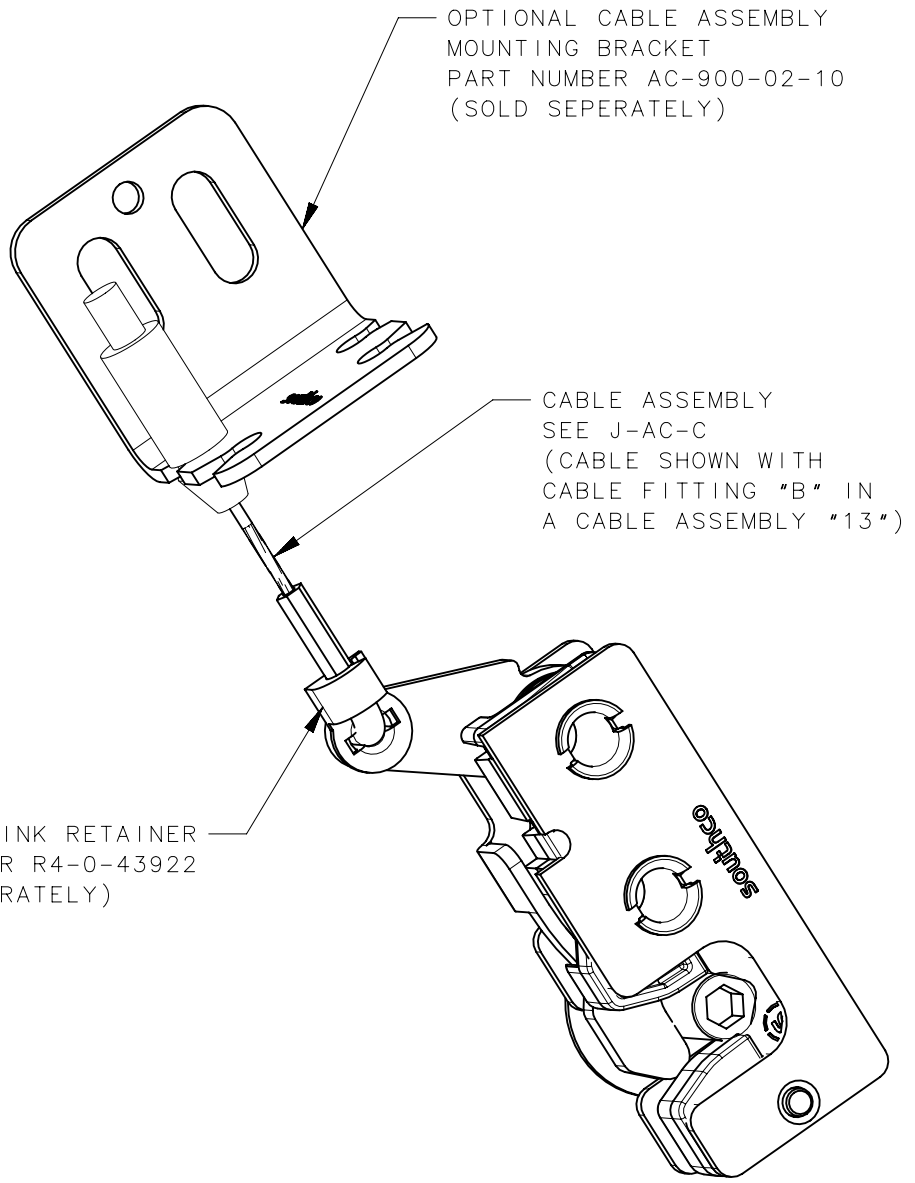

TOP ACTUATION SHOWN

THIRD ANGLE PROJECTION		<b>southco</b> <sup>®</sup> CONNECT • CREATE • INNOVATE	
MILLIMETERS [IN]			
TOLERANCES UNLESS OTHERWISE NOTED		DESCRIPTION R4 MINI ROTARY LATCH WITH RIGHT HAND - BSR INSERT	
ALL DIMENSIONS WITHOUT TOLERANCES ARE FOR REFERENCE ONLY.		SIZE B	SYSTEM NX
PROPRIETARY ITEM EXCEPT FOR USES EXPRESSLY GRANTED IN WRITING, INFORMATION DISCLOSED HEREON IS CONFIDENTIAL AND ALL RIGHTS, PATENT AND OTHERWISE, ARE RESERVED BY SOUTHCO, INC.		DWG NO. J-R4-10-5BR	DATE 16JUN2014
PER ASME Y14.5M-1994		DRAWN BY CMG/DGJ	SCALE 1:1
		SHEET 3 OF 3	

6

5

4

3

2

1