

# R4-30-3 I -70 B-M

| REVISION HISTORY |           |        |                 |
|------------------|-----------|--------|-----------------|
| REV              | DATE      | BY     | DESCRIPTION     |
| B                | 07APR2021 | ABK/VK | PRN: P2021-0655 |

- |                          |                     |                                |
|--------------------------|---------------------|--------------------------------|
| <b>I</b> MOUNTING OPTION | <b>B</b> LATCHING   | <b>M</b> MATERIAL              |
| 0 6.7 mm THRU HOLE       | 1 STANDARD          | 20 STAINLESS STEEL, PASSIVATED |
| 1 1/4-20 THREAD          | 5 INTEGRATED BUMPER |                                |
| 2 M6 THREAD              |                     |                                |

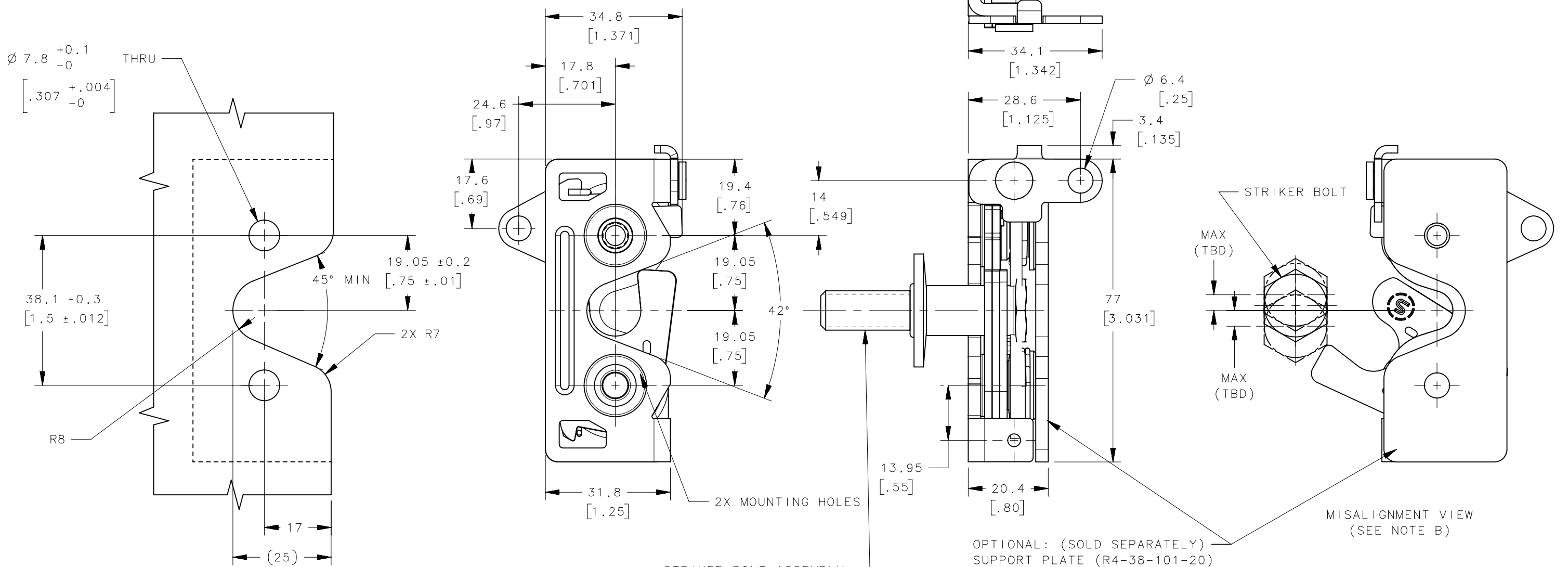
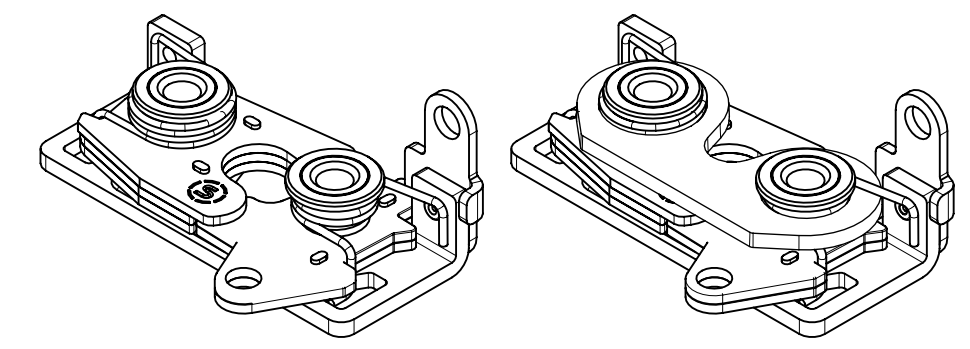

**NOTES:** **PANEL PREPARATION**

- A. MATERIAL AND FINISH:**
- HOUSING, LEVER AND INTERNAL COMPONENTS: STAINLESS STEEL, PASSIVATED
  - PAWL AND TRIGGER: STAINLESS STEEL, PASSIVATED
  - SPRING: STAINLESS STEEL, PASSIVATED
- B. THE MISALIGNMENT VIEW ASSUMES THE LATCH IS CONNECTED TO A PERFECTLY RIGID DOOR AND HINGE; THEREFORE, THERE IS NO DOOR AND/OR HINGE SLACK ASSOCIATED WITH THESE DIMENSIONS, THE MISALIGNMENT VIEW DOES NOT TAKE FLEXING OF THE STRIKER BOLT INTO ACCOUNT.**

STRIKER BOLT ASSEMBLY (SOLD SEPARATELY) SEE J-R4-90-321 FOR DETAILS

OPTIONAL: (SOLD SEPARATELY) SUPPORT PLATE (R4-38-101-20) SEE J-R4-38-101-20 FOR DETAILS

|  |                      |  |         |
|--|----------------------|--|---------|
| THIRD ANGLE PROJECTION   |                      |  |         |
| MILLIMETERS [IN]   |                      |  |         |
| TOLERANCES UNLESS OTHERWISE NOTED  |                      | DESCRIPTION  |         |
| ALL DIMENSIONS WITHOUT TOLERANCES ARE FOR REFERENCE ONLY.  |                      | R4 LATCH ASSEMBLY - BOTTOM PULLBACK RIGHT HAND ACTUATION STAINLESS STEEL |         |
| PROPRIETARY ITEM   | PER ASME Y14.5M-1994 | SIZE   | DWG NO. |
| EXCEPT FOR USES EXPRESSLY GRANTED IN WRITING, INFORMATION DISCLOSED HEREON IS CONFIDENTIAL AND ALL RIGHTS, PATENT AND OTHERWISE, ARE RESERVED BY SOUTHCO, INC. |                      | A3   | NX      |
|  |                      | DATE   | SCALE   |
|  |                      | 09JAN2017  | 1:1     |
|  |                      | DRAWN BY   | SHEET   |
|  |                      | RMO  | 1 OF 1  |